

STYLE 777SW

DOUBLE SEAL: STATIONARY, BALANCED CARTRIDGE SEAL WITH FLUSH AND BARRIER FLUID CAPABILITIES
 TENUTA DOPPIA STAZIONARIA A CARTUCCIA, DOPPIO BILANCIAMENTO CON FLUSSAGGIO E FLUIDO DI BARRIERA
 SELLO DE CARTUCHO ESTACIONARIO DOBLE, DOBLE EQUILIBRADO CON LAVADO Y LÍQUIDO BARRERA

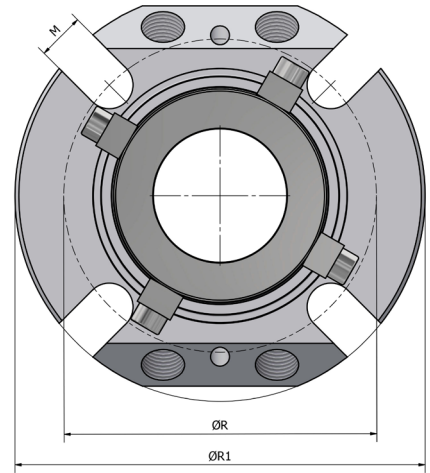
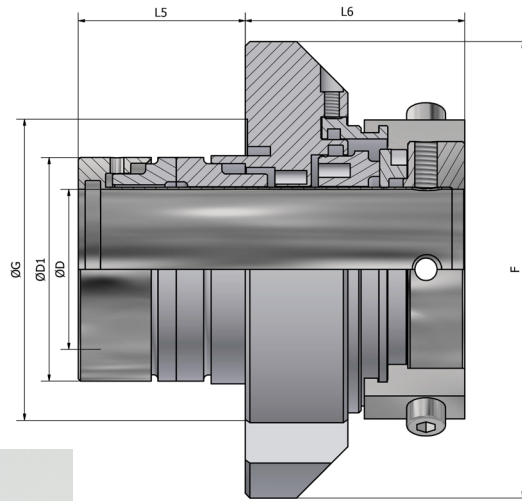

D	D	R	R1	M	F	L5	L6	D1	G
mm	inch	mm	mm	mm	mm	mm	mm	mm	mm
24,0	-	73,0	103,0	12,5	93,0	36,5	48,5	42,9	58,0
25,0	1000,0	73,0	103,0	12,5	93,0	36,5	48,5	42,9	58,0
28,0	1125,0	78,0	105,0	12,5	95,0	36,4	48,6	45,9	61,0
30,0	-	79,5	105,0	12,5	95,0	36,5	48,5	48,0	63,0
32,0	1250,0	82,5	108,0	12,5	100,0	36,5	48,5	50,0	65,5
33,0	-	82,5	108,0	12,5	100,0	36,5	48,5	50,0	65,5
35,0	1375,0	84,5	112,0	12,5	101,0	36,5	48,5	53,0	68,0
38,0	1500,0	87,0	118,0	12,5	106,0	36,5	48,5	56,0	72,0
40,0	-	90,0	124,0	12,5	110,0	36,5	48,5	58,0	73,0
42,0	-	96,0	140,0	14,5	120,0	36,5	48,5	60,8	75,5
43,0	1625,0	96,0	140,0	14,5	120,0	36,5	48,5	60,8	75,5
45,0	1750,0	96,0	140,0	14,5	125,0	36,5	48,5	63,0	77,8
48,0	1875,0	101,0	144,0	14,5	130,0	36,5	48,5	68,0	82,8
50,0	2000,0	101,0	144,0	14,5	130,0	36,5	48,5	68,0	82,8
53,0	2125,0	109,5	150,0	17,5	135,0	36,5	48,5	73,0	87,0
55,0	-	109,5	150,0	17,5	135,0	36,5	48,5	73,0	87,0
58,0	-	119,5	157,0	17,5	140,0	36,5	48,5	78,0	93,0
60,0	2250,0	119,5	157,0	17,5	140,0	36,5	48,5	78,0	93,0
-	2375,0	119,5	157,0	17,5	140,0	36,5	48,5	78,0	93,0
63,0	2500,0	126,5	165,0	17,5	149,0	38,5	48,5	87,4	101,5
65,0	-	126,5	165,0	17,5	149,0	38,5	48,5	87,4	101,5
68,0	2625,0	128,5	170,0	17,5	156,0	38,5	48,5	92,0	107,0
70,0	2750,0	128,5	170,0	17,5	156,0	38,5	48,5	92,0	107,0
-	2875,0	146,0	185,0	17,5	165,0	48,0	74,2	99,5	120,5
75,0	-	146,0	185,0	17,5	165,0	48,0	74,2	99,5	120,5
-	3000,0	152,5	190,0	17,5	171,0	50,6	64,0	104,5	130,0
80,0	3125,0	152,5	190,0	17,5	171,0	50,6	64,0	104,5	130,0
-	3250,0	162,0	195,0	17,5	176,0	50,7	63,0	109,5	132,8
85,0	3375,0	162,0	195,0	17,5	176,0	50,7	63,0	109,5	132,8
90,0	3500,0	170,5	210,0	20,5	179,2	48,5	65,5	114,5	140,8
-	3625,0	174,0	218,8	20,5	190,0	44,8	68,5	124,5	146,5
95,0	3750,0	174,0	218,8	20,5	190,0	44,8	68,5	124,5	146,5
100,0	3875,0	174,0	218,8	20,5	190,0	44,8	68,5	124,5	146,5

TECHNICAL DATA / DATI TECNICI

Metal parts <i>Parti metalliche</i>	G*
Elastomers <i>Elastomeri</i>	V - K - X1 - X*
Sliding faces <i>Facce di tenuta</i>	A - V2 - Q1 - Q2 - U2
Springs <i>Molle</i>	M5
Pressure <i>Pressione</i>	Vacuum/Vuoto 700 mm Hg + 25 Kg/cm ^{3**}
Temp	Upon elastomers <i>Secondo elastomeri</i>
Speed <i>Velocità</i>	25 m/sec Upon sliding faces material <i>Secondo materiale delle facce</i>
Dimensions <i>Dimensioni</i>	25-100 mm/1-4" ***

*Other materials, available upon request
 *Altri materiali disponibili su richiesta

**Upon shaft diameter and speed
 **Variabile in dipendenza al diametro e alla velocità

***Other sizes available up to 190mm
 ***Altre misure sono disponibili fino a 190mm



SEALTEK s.r.l.
 www.sealtek.com
 info@sealtek.com

All technical specifications contained in these technical data sheets are intended as guidelines. Sealtek s.r.l. must be informed about the precise conditions of application so that detailed information relating to specific cases can be provided.

06-2024